

11.

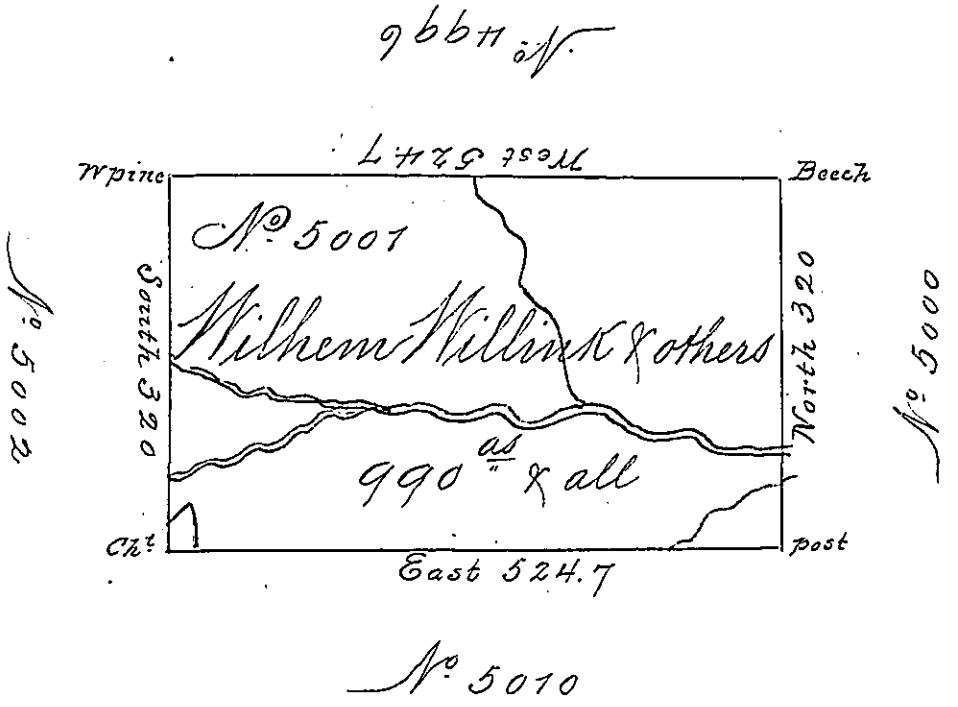

Situate on the Waters of Sinnamahoning Creek  
 in North<sup>d</sup> County containing 990<sup>As</sup> and the usual  
 Allowance for Roads. Surveyed the 19<sup>th</sup> day of July  
 1794 for Wilhem Killink and others in pursuance  
 of a Warrant No 5001 dated the 3<sup>rd</sup> day of February  
 1794

Daniel Brodhead Esq. S. G. John Canan D. S.

IN TESTIMONY that the above is a copy of the original remaining on file in the  
 Department of Internal Affairs of Pennsylvania, made con-  
 formably to an Act of Assembly approved the 16th day of  
 February, 1833. I have hereunto set my Hand and caused  
 the Seal of said Department to be affixed at Harrisburg, this  
 third day of September 1895.

James W. Latta  
 Secretary of Internal Affairs.